

PRELIMINARY DEVELOPMENT SCHEDULE

YEAR	MONTH	ITEM
2022	NOVEMBER	MASTERPLAN APPROVAL
2023	FEBRUARY	PHASE 1 STREET & UTILITY CONSTRUCTION
2023	JUNE	PHASE 1 HOUSING CONSTRUCTION
2023	JUNE	PHASE 2 STREET & UTILITY CONSTRUCTION
2023	OCTOBER	PHASE 2 HOUSING CONSTRUCTION
2023	OCTOBER	PHASE 3 STREET & UTILITY CONSTRUCTION
2024	FEBRUARY	PHASE 3 HOUSING CONSTRUCTION
2024	FEBRUARY	PHASE 4 STREET & UTILITY CONSTRUCTION
2024	JUNE	PHASE 4 HOUSING CONSTRUCTION
2024	JUNE	PHASE 5 STREET & UTILITY CONSTRUCTION
2024	OCTOBER	PHASE 5 HOUSING CONSTRUCTION

LEGEND

	DETACHED SINGLE FAMILY LOT (22)
	TOWNHOME LOT (46)
	MULTIFAMILY LOT(1)
	OPEN SPACE (3.17 ACRES, 31% OF NET AREA)

* FUTURE SITE PLAN APPLICATION REQUIRED PRIOR TO CONSTRUCTION OF MULTIFAMILY UNITS. DETAILS TO BE EVALUATED DURING SITE PLAN REVIEW PROCESS. DENSITY IS SUMMARIZED ON SHEET P2.4.

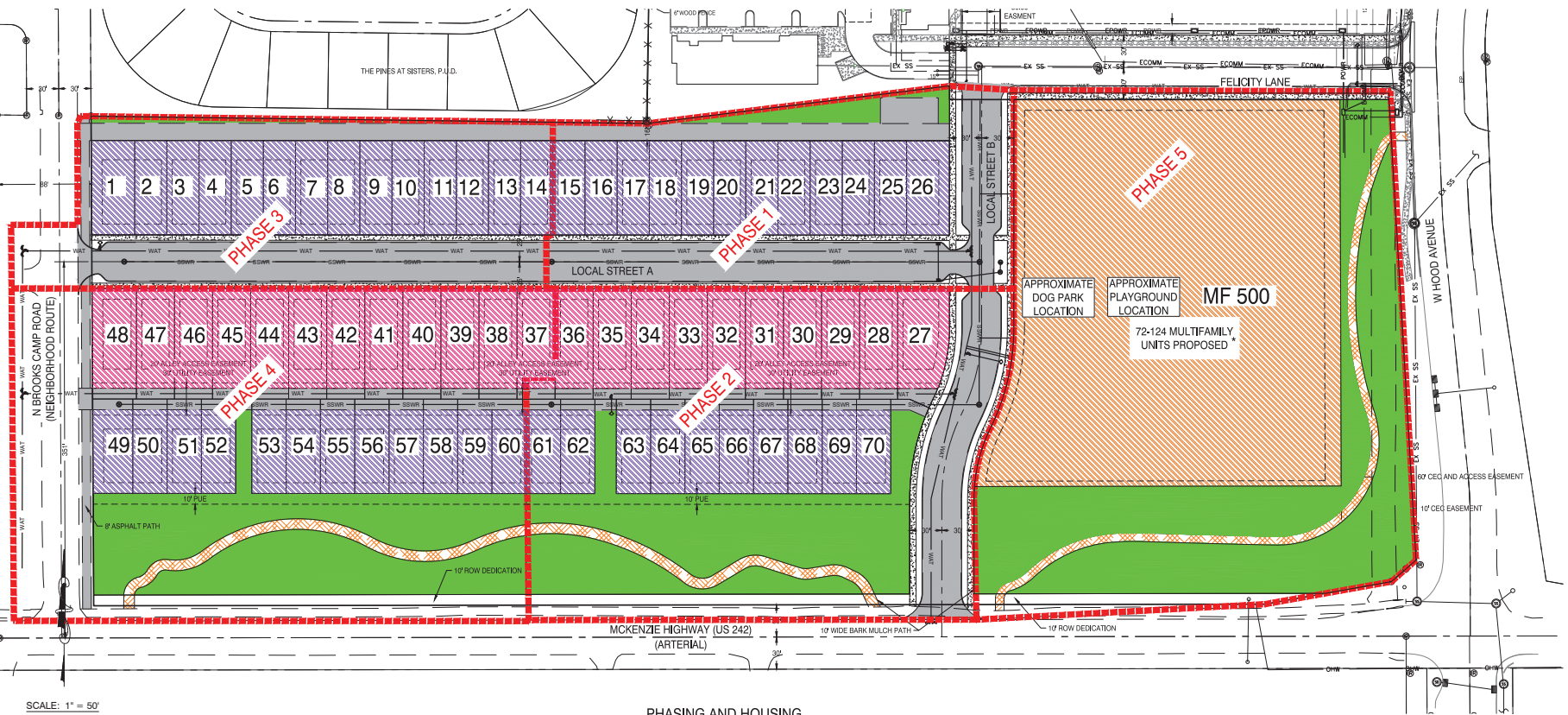

SCALE: 1" = 50'
FOR 34"x22" SHEETS

PHASING AND HOUSING DEVELOPMENT PLAN



DATE:	
No. REVISION:	
DATE:	10/10/22
DRAWING STATUS:	MASTER PLAN



PROJECT: SUNSET MEADOWS MASTER PLAN AND SUBMISSION
PROJECT LOCATION: SISTERS, OR
CLIENT: WOODHILL HOMES

SHEET TITLE: PHASING AND HOUSING DEVELOPMENT PLAN

JOB NO. 21-041
DRAWN BY: EDN
DRAWING: P1.4